

# How to use a HITACHI wall mount control

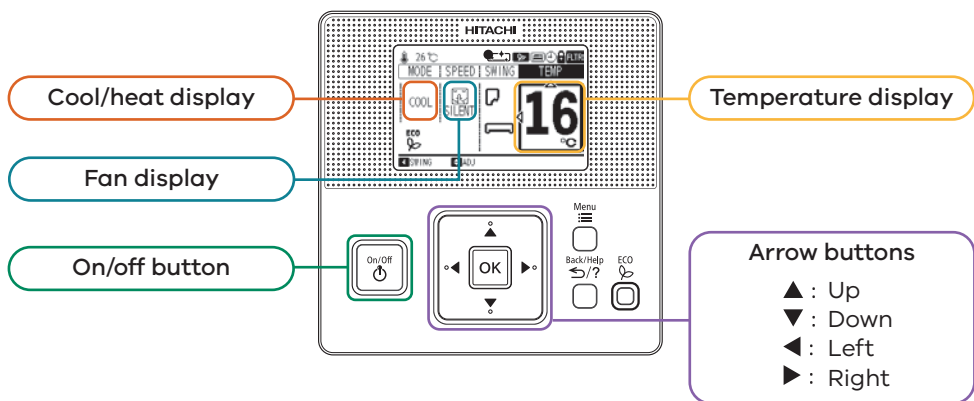

## General Information

- On very cold mornings, it can take up to 25 minutes for the unit to defrost and begin blowing warm air after it's turned on.
- The thermostat will make the unit turn off and on to keep the room at the selected temperature.

## Turning the unit on and off

1. Turn on the unit by pressing the on/off button once (a light will indicate the unit is on).
2. Once on, to turn off, press the on/off button once.

## How to select the cooling or heating mode

1. Press the ◀ **left** and ▶ **right arrows** until **Mode** setting is selected.
2. Press the ▲ **up** and ▼ **down arrows** until either **Cool** or **Heat** is selected (ignore the other options).

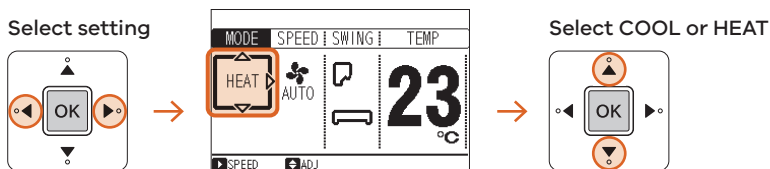

## How to change the temperature

1. Press the ◀ **left** and ▶ **right arrows** until **Temperature** setting is selected.
2. Press the ▲ **up** and ▼ **down arrows** to select the desired temperature.

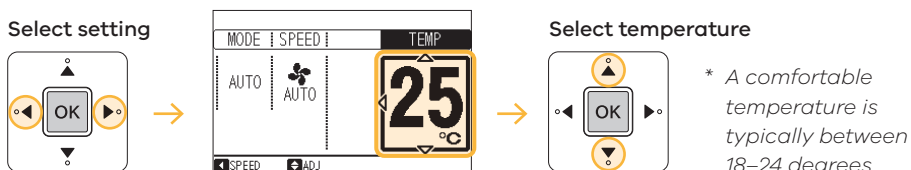

## How to select the fan speed

1. Press the ◀ **left** and ▶ **right arrows** until **Fan speed** setting is selected.
2. Press the ▲ **up** and ▼ **down arrows** to select the desired fan speed.

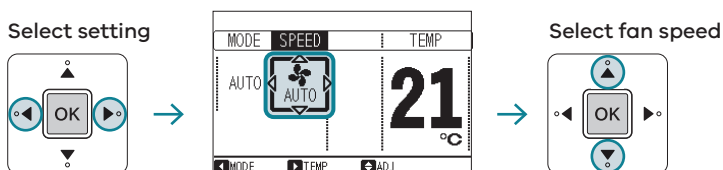

**Find out more:** You can access the full instruction manual for the wall mount control at the following web site:

<https://tinyurl.com/ycxnypw4>

